

Audio Guide System HearoGuide 200+ Charger

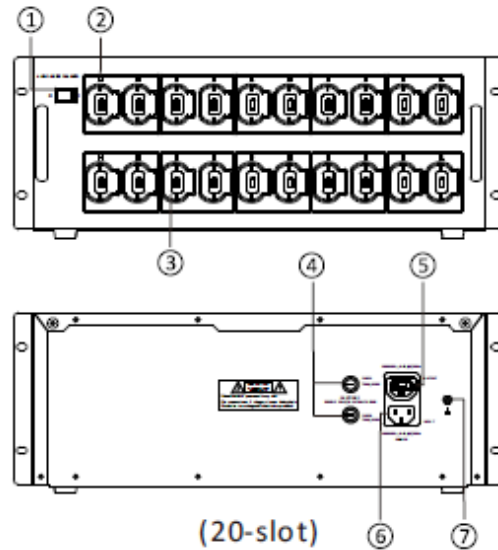
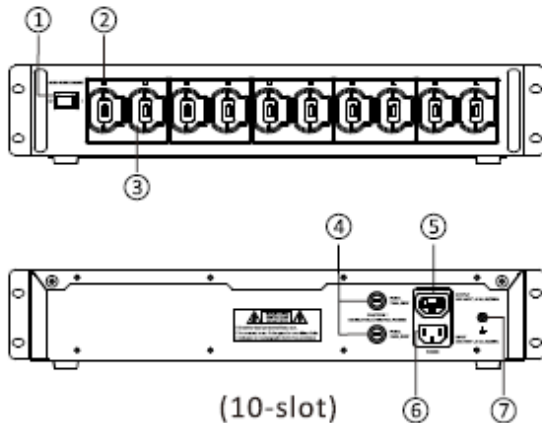

■ Illustration

- ① Power switch and power indicator
- ② Charging indicator
- ③ Charging slot
- ④ Fuse
- ⑤ Power output connector
- ⑥ Power input connector
- ⑦ Grounding

■ Instructions

- ① Power ON : Red indicator; Power OFF : indicator OFF
- ② Charging : Blue charging indicator
Fully charged : charging indicator OFF
Charging error : blinking indicator
- ③ 10-slot : 10 charging pockets for audioguide
20-slot : 20 charging pockets for audioguide
- ④ 10-slot charger : AC 250 V, 2 A
20-slot charger : AC 250 V, 3 A
- ⑤ Supplying power to another charger with a connective cable
※ 10-slot charger: maximum 6 chargers in a daisy chain.
※ 20-slot charger: maximum 3 chargers in a daisy chain.
- ⑥ AC 100 - 240 V, 50/60 Hz
- ⑦ Ground the device when required

■ Operation

Power ON

- Connect power cord with mains.
- Switch it on and observe if the charger will perform a charging test or not – charging indicators will light in Blue for about 2 seconds.

Charging

- Allocate audioguide into charging pockets.
- Charging indicators will light in Blue; indicator on audioguide will light in Red.
- When there is a blinking indicator on audioguide, the charging is not performed. Please refer to troubleshooting or find local dealer for repair if you are unable to sort it out.
- Fully charged = charging indicators OFF = Green indicator (audioguide).

■ Troubleshooting

- Q. Charging indicator is OFF when audioguide allocated onto charging pockets
- A. Make sure charging contacts are not covered with dust, not deformed, or the battery is actually at full capacity.

■ Troubleshooting

- Q. Indicator blinks in blue
- A. Make sure audioguide is on charging mode, not data uploading mode. Please refer to audioguide manual for further details.
- Q. Power/charging indicator is OFF when powered on
- A. Make sure power cord and fuse are installed or connected well.

■ Warning

- ※ Keep this charger away from any heat source and allocated with good ventilation. Do not leave it under sunlight or close to heater.
- ※ Clean charging contacts regularly to prevent contact failure caused by dust.
- ※ Use power supply that comes with original package only.
- ※ Improper squeeze or remove is not allowed.
- ※ Do not open charger enclosure in case of electronic shock.
- ※ Do not connect outnumbered chargers in a daisy chain.

■ Specifications

Charger Specifications	10-slot	20-slot
Charging pockets	10	20
Charging indicator	Blue = charging Blinking = error Off = fully charged	
Charging current	300 mA, per pocket	
Charging time	5-6 hours, based on Lithium 1200 mAh	
Required power	AC 100-240 V, 50/60 Hz, 8-4 A	
Rated charger no.	6, per daisy chain	3, per daisy chain
Ambient temp.	-10 °C ~ 50 °C	
Fuse	AC 250 V, 2 A	AC 250 V, 3 A
Dimensions (DxWxH)	237x482x88.4	237x482x177
Weight	3.6 kg	5.1 kg

※ Specifications are subject to change

IMTRADEX HÖR-SPRECHSYSTEME GesmbH

Pombergerweg 292a • A-1220 Wien / Austria • Telefon: +43 / 1 / 20 44 294-0 • Telefax: +43 / 1 / 2044294-18
 email: headsets@imtradex.at • Bankverbindung: Erste Bank • IBAN: AT88 2011 1286 1836 0600 • BIC: GIBAAATWW
 registr. beim Handelsgericht Wien FN 495535d • UID-Nr. ATU73523458 • www.headsets.at • www.imtradex.at

Installation for multiple chargers

Follow illustration below to connect and expand chargers on demand.

※ For safety purpose, link chargers within rated number only. (find rated charger mix below for your referral.)

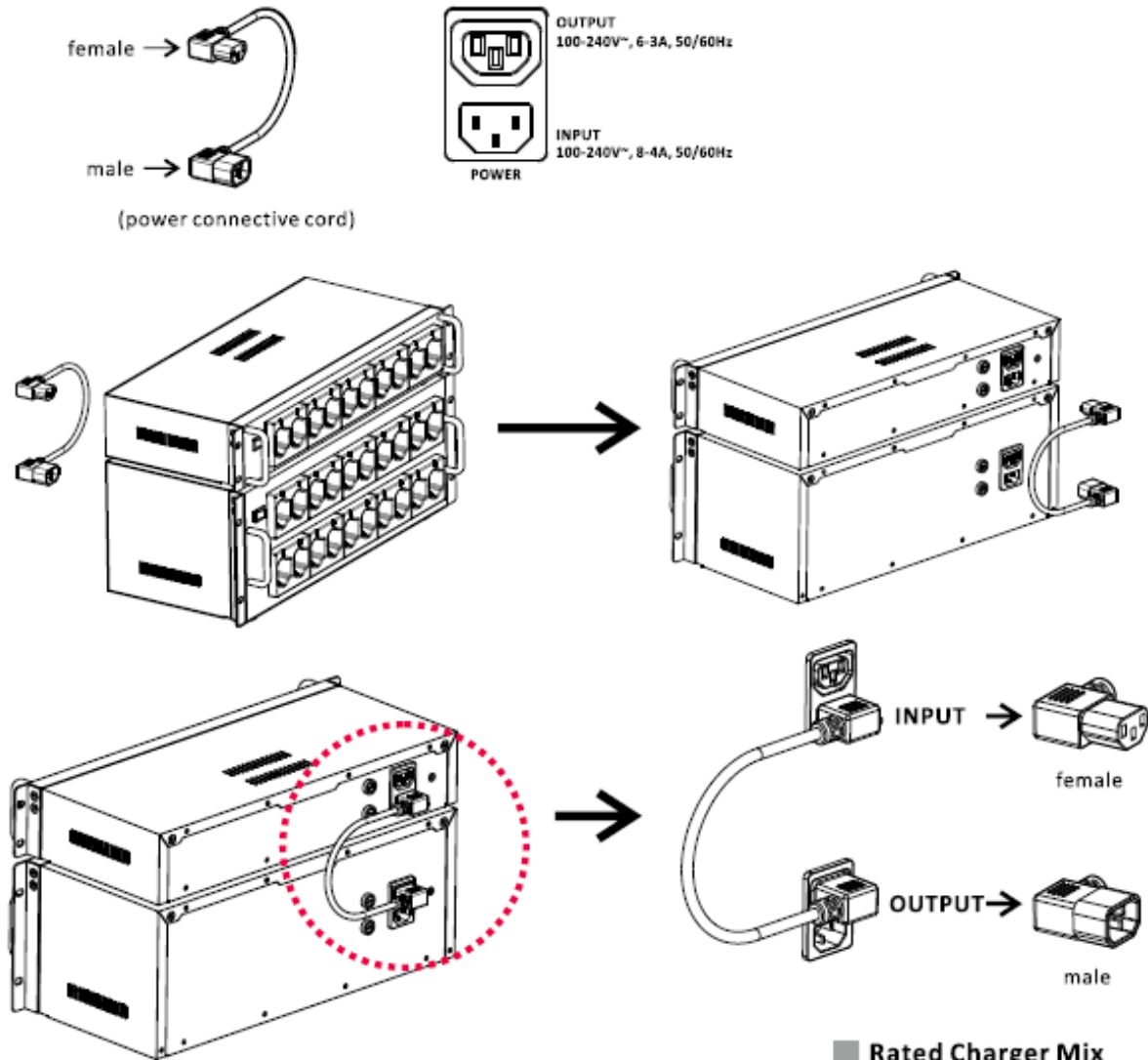

Rated Charger Mix

Charger Mix	10-slot	20-slot
A	0	3
B	1	2
C	2	2
D	3	1
E	4	1
F	5	0
G	6	0

※ Specifications are subject to change

IMTRADEX HÖR-SPRECHSYSTEME GesmbH

Pombergerweg 292a • A-1220 Wien / Austria • Telefon: +43 / 1 / 20 44 294-0 • Telefax: +43 / 1 / 2044294-18
 email: headsets@imtradex.at • Bankverbindung: Erste Bank • IBAN: AT88 2011 1286 1836 0600 • BIC: GIBAATWW
 registr. beim Handelsgericht Wien FN 49535d • UID-Nr. ATU73523458 • www.headsets.at • www.imtradex.at