

Wireless Window Intercom

Install

In position ^{N1}

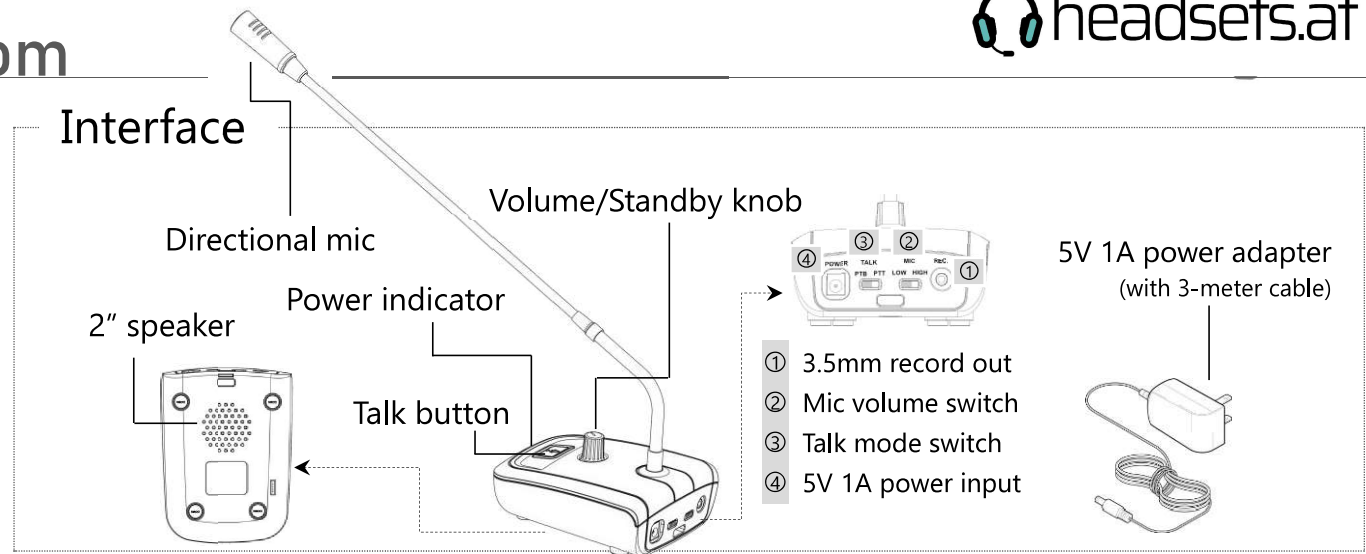
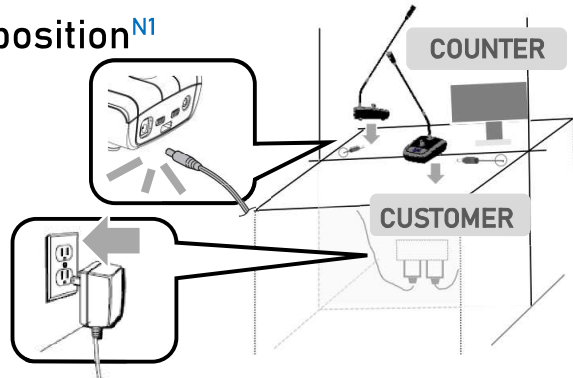

Paired & Ready to work

1 COUNTER side. Keep and hold the mic button when connected to power. Then, release the button.

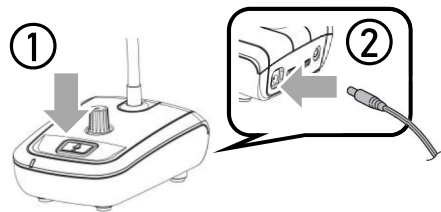

2 Power indicator starts to flash quickly.

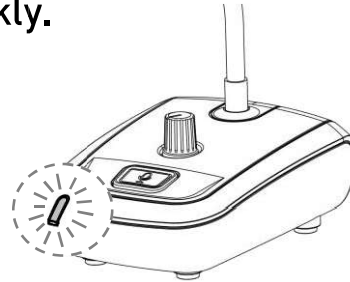

3 CUSTOMER side. Power connected.

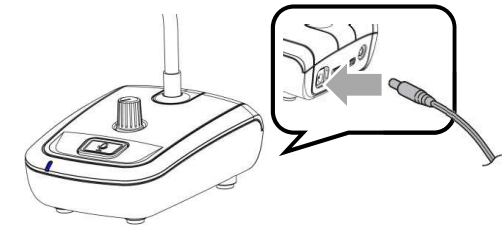

4 Power indicators stay blue on both speaker pods.

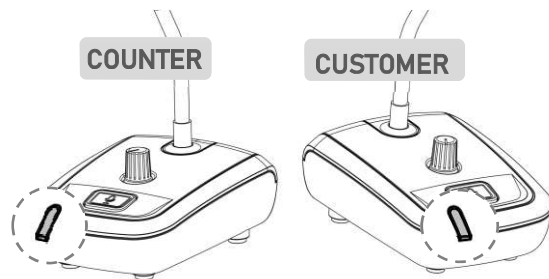

5 Paired ^{N2}.

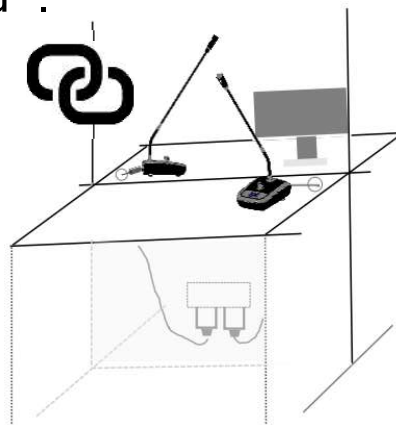

6 Repeat step 1-5 ^{N3} to pair in sequence ^{N4}.

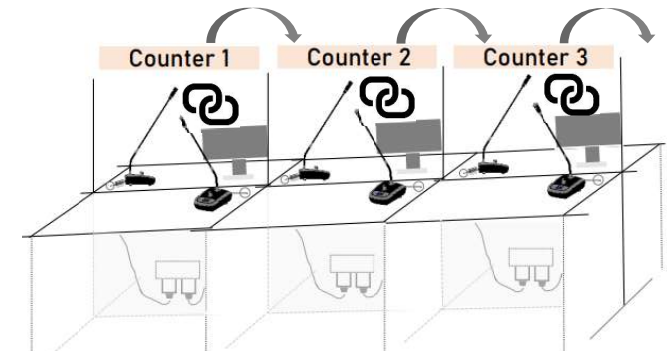

Mic positioning

Ensure the system is positioned at 15-30 cm distance between the mic and your mouth. Note defined distance still varies upon talker's voice and surrounding noise. It is recommended to properly adjust mic/speaker volume beforehand.

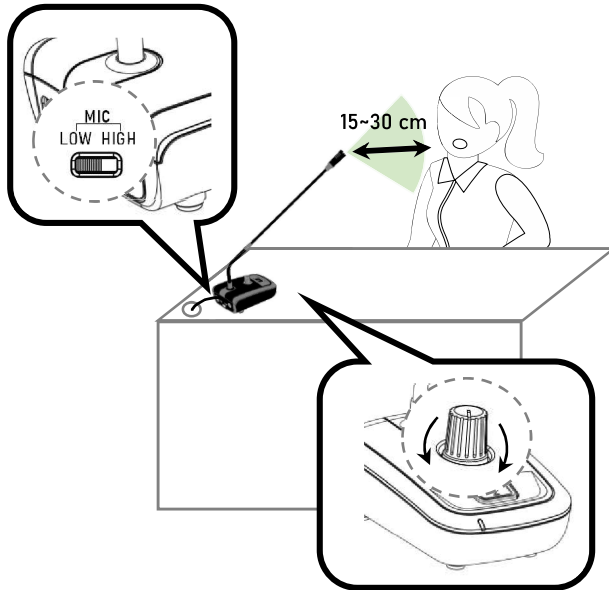

Voice recording

3.5 mm recording jack (TRS) on the back side is available for conversation recording (if needed).

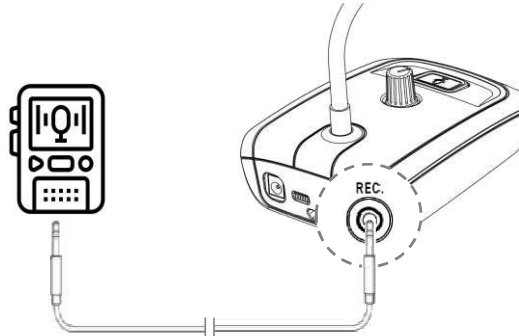

System closed (standby mode)

COUNTER side. Tune its volume knob ^{N5} counterclockwise till standby sound beeps. Power indicators on both paired COUNTER and CUSTOMER sides turn to flash slowly.

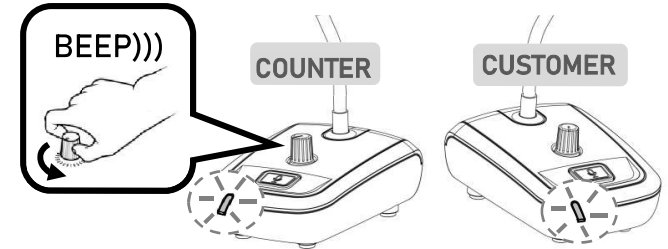

Specifications

Gooseneck Mic		Speaker Pod	
Polar pattern	Directional	Size	2"
Capsule	Electret condenser	Output power _{RMS}	1.5 W
Frequency response	50 – 16000 Hz	Frequency response	120 – 15000 Hz
Sensitivity	-44±3 dB	Impedance	4 Ω
Voice pickup range	15 ^{MIC Low} ~ 30 ^{MIC High} cm	Max. SPL _{0.1M/1W}	97±3 dB
Overall			
Frequency	823 ~ 832 + 863 ~ 865 MHz ; 863 ~ 865 MHz		
Operation range	~15 meters		
Dimensions	Mic length 456±3 mm Speaker pod 99.8x61.5x132.9 mm		
Weight	Main body 317 g Power adapter 138 g		

Specifications subject to change without notice.



^{N1} Distance **> 1 meter** (when MIC Low) among COUNTERS is recommended.

^{N2} Pairing distance between COUNTER and CUSTOMER is **< 3 meters**.

^{N3} Keep all paired systems **ON** until pairing installation finishes.

^{N4} Be sure to activate and pair each system **one by one**.

^{N5} **COUNTER** side. Tune its volume knob clockwise/counterclockwise to start/end everyday work.